

Items

- Apron
- towel
- old t-shirt
- Covered plastic container
- 1/2 - 1 gal. size

Mudfish Pottery - Lou D'Amico  
 2281 Wilbur SW  
 ABQ NM, 87105

505-873-0609

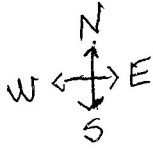

Material fee  
 \$50 + tax  
 \$53.44  
 We do not take  
 Credit Cards

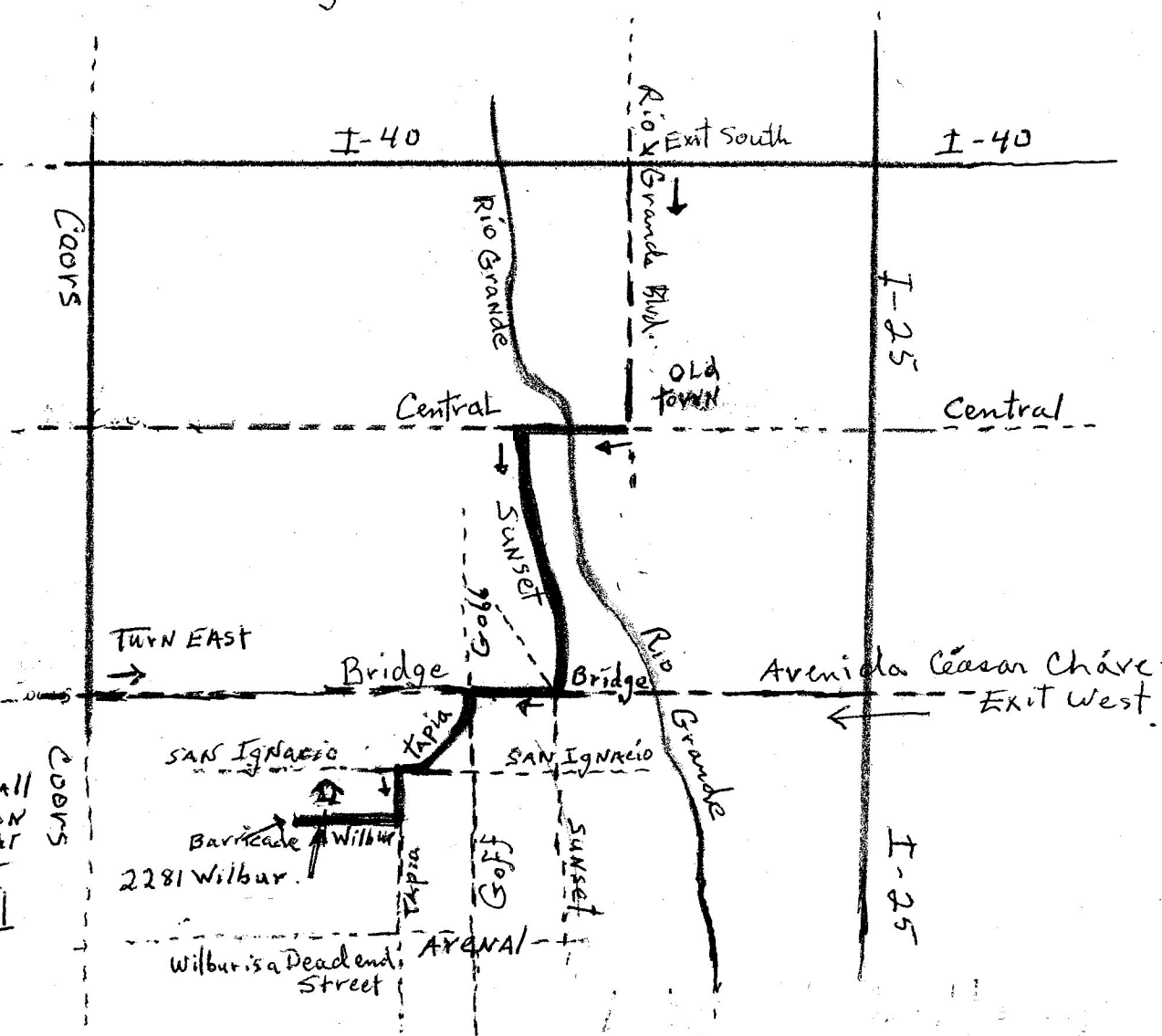

\* Look for a small wooden sign on a tree - right side of street  
 2281

Directions to Mudfish Pottery

From I-25: go west at the Avenida Cesar Chavez exit. Continue West to Goff, and then turn left.

From the West Side: Take Coors, go East on Bridge to Goff. Turn Right,

From Central and Rio Grande: take Central west to Sunset (first light over the river), turn left (south) onto Sunset, and continue to Bridge. At Bridge, go west (right) to Goff, then left on Tapia

\* At Bridge and Goff go south and bear right immediately onto Tapia. Turn right at San Ignacio, then left back onto Tapia. Take the first right at Wilbur and continue to #2281. on right.